

# ADAPTEURS - SOMMAIRE -



## JIC 37°

	page
Union Egale	02.03.005
Coude Egal à 90°	02.03.005
Té Egal	02.03.005
Croix Egale	02.03.005
Union Egale Traversée de Cloison	02.03.010
Coude à 90° Traversé de Cloison	02.03.010
Coude à 45° Traversé de Cloison	02.03.010
Té Egal Traversé de Cloison au centre	02.03.010
Coude Egal Tournant à 90°	02.03.015
Coude Egal Tournant à 45°	02.03.015
Té Egal Tournant au centre	02.03.015
Té Egal Tournant Renversé	02.03.015
Mâle JIC X Mâle NPTF	02.03.020
Coude Mâle JIC X Mâle NPTF 45°	02.03.025
Coude Mâle JIC X Mâle NPTF 90°	02.03.030
Té Mâle JIC X Mâle NPTF au centre	02.03.030
Té Mâle JIC X Mâle NPTF Renversé	02.03.035
Mâle JIC X Femelle NPTF	02.03.035
Coude Mâle JIC X Femelle NPTF 90°	02.03.035
Té Mâle JIC X Femelle NPTF au centre	02.03.040
Té Mâle JIC X Femelle NPTF Renversée	02.03.040
Femelle JIC Tournant X Mâle NPTF	02.03.040
Mâle JIC X Mâle Gaz Conique	02.03.045
Coude Mâle JIC X Mâle Gaz Conique 90°	02.03.050
Coude Mâle JIC X Mâle Gaz Conique 45°	02.03.050
Mâle JIC X Mâle Gaz Cylindrique (bague+joint)	02.03.055
Coude Mâle JIC X Mâle Gaz Cylindrique (bague+joint) 90°	02.03.060
Coude Mâle JIC X Mâle Gaz Cylindrique (bague+joint) 45°	02.03.060
Té Mâle JIC X Mâle Gaz Cylindrique (bague+joint) au centre	02.03.065
Té Mâle JIC X Mâle Gaz Cylindrique (bague+joint) Renversé	02.03.065
Mâle JIC X Femelle Gaz Cylindrique	02.03.065
Femelle JIC X Mâle Gaz Conique	02.03.070
Femelle JIC X Mâle Gaz Cylindrique (bague+joint)	02.03.070
Mâle JIC X Mâle Métrique Cylindrique (bague+joint)	02.03.075
Coude Mâle JIC X Mâle Métrique Cylindrique (bague+joint) 90°	02.03.075
Femelle JIC X Mâle Métrique Cylindrique (bague+joint)	
Union Inégale Mâle JIC X Mâle JIC	02.03.080
Coude Inégal Mâle JIC X Mâle JIC 90°	02.03.080
Réduction Femelle JIC X Mâle JIC	02.03.085
Ecrou Hexagonal Tube Métrique	02.03.085
Bouchon Femelle JIC	02.03.090
Bouchon Mâle JIC	02.03.090
Manchette Tube Métrique	02.03.090

Suite →

# ADAPTEURS - SOMMAIRE -



## BSP / BSPT

	page
Mâle BSP (cône 60°) X Mâle BSP (cône 60°)	02.10.005
Mâle BSP (cône 60°) X Mâle Gaz Conique	02.10.005
Femelle BSP (cône 60°) X Mâle Gaz Conique	02.10.010
Même BSP (cône 60°) X Femelle BSP (cône 60°)	02.10.010
Mâle GAZ Conique X Mâle Gaz Conique	02.10.010
Mâle GAZ Conique X Mâle NPT	02.10.015
Mâle Gaz Conique X Femelle Gaz Cylindrique	02.10.015
Coude Mâle Gaz Conique X Femelle Gaz Cylindrique 90°	02.10.015
Femelle Gaz Cylindrique X Femelle Gaz Cylindrique	02.10.020
Coude Femelle Gaz Cylindrique X Femelle Gaz Cylindrique 90°	02.10.020
Té Egal Femelle Gaz Cylindrique	02.10.020

## NPT

	page
Mâle NPT X Mâle NPT	02.11.005
Réduction Femelle NPT X Mâle NPT	02.11.005
Coude Mâle NPT X Mâle NPT 90°	02.11.010
Coude Mâle NPT X Femelle NPT 90°	02.11.010
Mâle NPT X Mâle BSP (cône 60°)	02.11.015

## BOUCHON

	page
Bouchon Mâle NPT	02.12.005
Bouchon Mâle BSP (cône 60°)	02.12.005
Bouchon Mâle Gaz Conique	02.12.005

← Précédent

Union Egal			
Diamètre tube		JIC 37°	Référence
mm	inch		
1/4"	6	7/16"	47910061
5/16"	8	1/2"	47910062
3/8"	10	9/16"	47910063
1/2"	12	3/4"	47910064
5/8"	16	7/8"	47910065
3/4"	20	1"1/16	47910066
1"	25	1"5/16	47910067
1"1/4	32	1"5/8	47910068
1"1/2	38	1"7/8	47910069
2"	42	2"1/2	47910070



Coude Egal à 90°			
Diamètre tube		JIC 37°	Référence
mm	inch		
1/4"	6	7/16"	47910431
5/16"	8	1/2"	47910432
3/8"	10	9/16"	47910433
1/2"	12	3/4"	47910434
5/8"	16	7/8"	47910435
3/4"	20	1"1/16	47910436
1"	25	1"5/16	47910437
1"1/4	32	1"5/8	47910438
1"1/2	38	1"7/8	47910911
2"	42	2"1/2	47910439

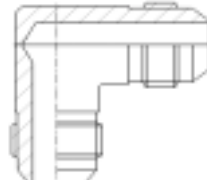

Té Egal			
Diamètre tube		JIC 37°	Référence
mm	inch		
1/4"	6	7/16"	47911124
5/16"	8	1/2"	47911125
3/8"	10	9/16"	47911126
1/2"	12	3/4"	47911127
5/8"	16	7/8"	47911128
3/4"	20	1"1/16	47911129
1"	25	1"5/16	47911130
1"1/4	32	1"5/8	47911800
1"1/2		1"7/8	47911838
2"	42	2"1/2	47911839

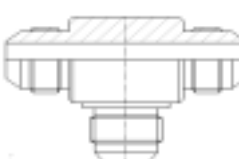

Croix Egal			
Diamètre tube		JIC 37°	Référence
mm	inch		
1/4"	6	7/16"	47911200
5/16"	8	1/2"	47911201
3/8"	10	9/16"	47911202
1/2"	12	3/4"	47911203
5/8"	16	7/8"	47911204
3/4"	20	1"1/16	47911206
1"	25	1"5/16	47911207

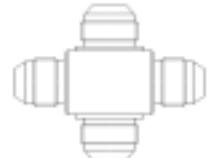

## Union Egal Traversée de Cloison

Diamètre tube		JIC 37°	Référence
mm	inch		
1/4"	6	7/16"	47910722
5/16"	8	1/2"	47910723
3/8"	10	9/16"	47910724
1/2"	12	3/4"	47910725
5/8"	16	7/8"	47910726
3/4"	20	1"1/16	47910727
1"	25	1"5/16	47910728
1"1/4	32	1"5/8	47911700
1"1/2	38	1"7/8	47911695



## Coude Egal à 90° Traversé de Cloison

Diamètre tube		JIC 37°	Référence
mm	inch		
1/4"	6	7/16"	47910475
5/16"	8	1/2"	47910476
3/8"	10	9/16"	47910477
1/2"	12	3/4"	47910478
5/8"	16	7/8"	47910479
3/4"	20	1"1/16	47910480
1"	25	1"5/16	47910481
1"1/4	32	1"5/8	47910944
1"1/2	38	1"7/8	47912200

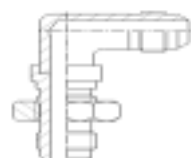

## Coude Egal à 45° Traversé de Cloison

Diamètre tube		JIC 37°	Référence
mm	inch		
1/4"	6	7/16"	47911003
5/16"	8	1/2"	47911004
3/8"	10	9/16"	47911005
1/2"	12	3/4"	47911006
5/8"	16	7/8"	47911007
3/4"	20	1"1/16	47911008
1"	25	1"5/16	47911009
1"1/4	32	1"5/8	47911030



## Té Egal Traversé de Cloison au centre

Diamètre tube		JIC 37°	Référence
mm	inch		
1/4"	6	7/16"	47912240
5/16"	8	1/2"	47912245
3/8"	10	9/16"	47912241
1/2"	12	3/4"	47912242
5/8"	16	7/8"	47912243
3/4"	20	1"1/16	47912244



# JIC 37°



[Sommaire](#)

## Coude Egal Tournant à 90°

Diamètre tube		JIC 37°	Référence
mm	inch		
6	1/4"	7/16"	47910986
8	5/16"	1/2"	47910987
10	3/8"	9/16"	47910988
12	1/2"	3/4"	47910989
16	5/8"	7/8"	47910990
20	3/4"	1"1/16	47910991
25	1"	1"5/16	47910992
32	1"1/4"	1"5/8	47910993
38	1"1/2"	1"7/8	47912205

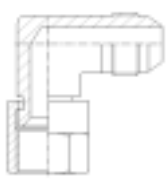

## Coude Egal Tournant à 45°

Diamètre tube		JIC 37°	Référence
mm	inch		
1/4"	6	7/16"	47911053
5/16"	8	1/2"	47911054
3/8"	10	9/16"	47911055
1/2"	12	3/4"	47911056
5/8"	16	7/8"	47911057
3/4"	20	1"1/16	47911058
1"	25	1"5/16	47911059
1"1/4"	32	1"5/8	47911060

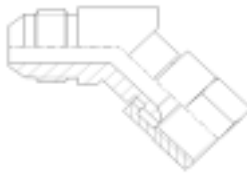

## Té Egal Tournant au centre

Diamètre tube		JIC 37°	Référence
mm	inch		
1/4"	6	7/16"	47911808
5/16"	8	1/2"	47911809
3/8"	10	9/16"	47911810
1/2"	12	3/4"	47911811
5/8"	16	7/8"	47911812
3/4"	20	1"1/16	47911813
1"	25	1"5/16	47911814
1"1/4"	32	1"5/8	47911815
1"1/2"		1"7/8	47912186

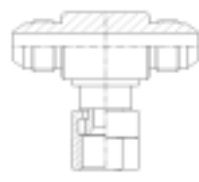

## Té Egal Tournant Renversé

Diamètre tube		JIC 37°	Référence
mm	inch		
1/4"	6	7/16"	47911816
5/16"	8	1/2"	47911817
3/8"	10	9/16"	47911818
1/2"	12	3/4"	47911819
5/8"	16	7/8"	47911820
3/4"	20	1"1/16	47911821
1"	25	1"5/16	47911822
1"1/4"	32	1"5/8	47911823
1"1/2"	38	1"7/8	47912184

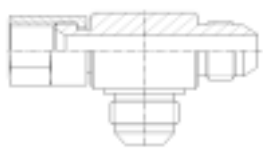

## Mâle JIC X Mâle NPTF

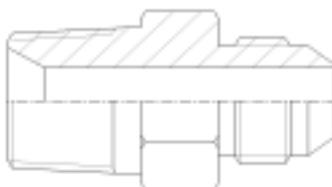

Diamètre tube		JIC	NPTF	Référence
mm	inch			
1/4"	6	7/16"	1/8"	47910081
			1/4"	47910083
			3/8"	47910074
			1/2"	47910755
5/16"	8	1/2"	1/8"	47910082
			1/4"	47910084
			3/8"	47910075
3/8"	10	9/16"	1/8"	47910756
			1/4"	47910085
			3/8"	47910086
			1/2"	47910076
1/2"	12	3/4"	1/4"	47910071
			3/8"	47910087
			1/2"	47910088
			3/4"	47910090
5/8"	16	7/8"	3/8"	47910130
			1/2"	47910089
			3/4"	47910091
3/4"	20	1"1/16	1/2"	47910073
			3/4"	47910092
			1"	47910094
1"	25	1"5/16	3/4"	47910093
			1"	47910095
			1"1/4	47910096
1"1/4	32	1"5/8	1"	47911703
			1"1/4	47910097
			1"1/2	47911704
1"1/2	38	1"7/8	1"1/2	47910098
2"	42	2"1/2	2"	47910099
		3"	2"1/2	47910072
		3" 1/2	3"	47910077

**GECI**  
**Fabricant français**

## Coude Mâle JIC X Mâle NPTF 45°

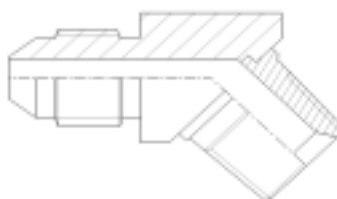

Diamètre tube		JIC	NPTF	Référence
mm	inch			
1/4"	6	7/16"	1/8"	47910301
			1/4"	47910303
5/16"	8	1/2"	1/8"	47910302
			1/4"	47910304
3/8"	10	9/16"	1/8"	47911192
			1/4"	47910305
			3/8"	47910306
			1/2"	47910757
1/2"	12	3/4"	1/4"	47912206
			3/8"	47910307
			1/2"	47910308
			3/4"	47911193
5/8"	16	7/8"	3/8"	47911194
			1/2"	47910309
			3/4"	47910310
3/4"	20	1"1/16	1/2"	47911031
			3/4"	47910311
			1"	47910313
1"	25	1"5/16	3/4"	47910312
			1"	47910314
1"1/4	32	1"5/8	1"	47911027
			1"1/4	47910316
1"1/2	38	1"7/8	1"1/2	47910318

**Livraison sous 24 heures**

## Coude Mâle JIC X Mâle NPTF 90°

Diamètre tube		JIC	NPTF	Référence
mm	inch			
1/4"	6	7/16"	1/8"	47910331
			1/4"	47910333
			3/8"	47910336
			1/2"	47910947
5/16"	8	1/2"	1/8"	47910332
			1/4"	47910334
			3/8"	47910948
3/8"	10	9/16"	1/8"	47910353
			1/4"	47910335
			3/8"	47910337
			1/2"	47910354
1/2"	12	3/4"	1/4"	47910356
			3/8"	47910338
			1/2"	47910339
			3/4"	47910342
5/8"	16	7/8"	3/8"	47910355
			1/2"	47910340
			3/4"	47910343
3/4"	20	1"1/16	1/2"	47910341
			3/4"	47910344
			1"	47910346
1"	25	1"5/16	3/4"	47910345
			1"	47910347
			1"1/4	47910348
1"1/4	32	1"5/8	1"	47910949
			1"1/4	47910349
			1"1/2	47910350
1"1/2	38	1"7/8	1"1/2	47910351
2"	42	2"1/2	2"	47910352
			3"	47910357

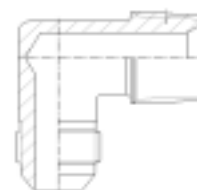

## Té Mâle JIC X Mâle NPTF au centre

Diamètre tube		JIC	NPTF	Référence
mm	inch			
1/4"		7/16"	1/8"	47911104
			1/4"	47911105
5/16"	8	1/2"	1/8"	47911106
			1/4"	47911108
3/8"	10	9/16"	1/4"	47911107
			3/8"	47911195
1/2"	12	3/4"	3/8"	47911109
			1/2"	47911110
5/8"	16	7/8"	1/2"	47911111
3/4"	20	1"1/16	3/4"	47911112
1"	25	1"5/16	1"	47911113
1"1/4	32	1"5/8	1"1/4	47912185

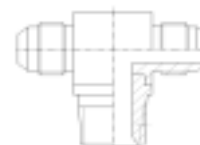

## Té Mâle JIC X Mâle NPTF Renversé

Diamètre tube		JIC	NPTF	Référence
mm	inch			
1/4"	6	7/16"	1/8"	47911131
			1/4"	47911132
5/16"	8	1/2"	1/8"	47911133
			1/4"	47911134
3/8"	10	9/16"	1/4"	47911135
			3/8"	47911137
1/2"	12	3/4"	3/8"	47911136
			1/2"	47911191
5/8"	16	7/8"	1/2"	47911138
3/4"	20	1"1/16	3/4"	47911139
1"	25	1"5/16	1"	47911140
1"1/4	32	1"5/8	1"1/4	47912198

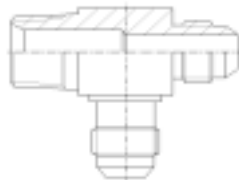

## Mâle JIC X Femelle NPTF

Diamètre tube		JIC	NPTF	Référence
mm	inch			
1/4"	6	7/16"	1/8"	47910241
			1/4"	47910243
5/16"	8	1/2"	1/8"	47910242
			1/4"	47910244
3/8"	10	9/16"	1/4"	47910245
			3/8"	47910246
1/2"	12	3/4"	3/8"	47910247
			1/2"	47910254
5/8"	16	7/8"	1/2"	47910248
3/4"	20	1"1/16	1/2"	47911771
			3/4"	47910249
1"	25	1"5/16	1"	47910250
1"1/4	32	1"5/8	1"1/4	47910251
1"1/2	38	1"7/8	1"1/2	47910252
2"	50	2"1/2	2"	47910253

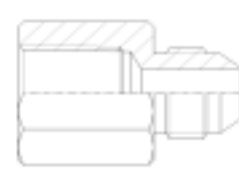

## Coude Mâle JIC X Femelle NPTF 90°

Diamètre tube		JIC	NPTF	Référence
mm	inch			
1/4"	6	7/16"	1/8"	47910449
			1/4"	47910450
5/16"	8	1/2"	1/8"	47910451
			1/4"	47910452
3/8"	10	9/16"	1/8"	47910983
			1/4"	47910453
			3/8"	47910454
1/2"	12	3/4"	1/4"	47910984
			3/8"	47910455
			1/2"	47910456
5/8"	16	7/8"	1/2"	47910457
3/4"	20	1"1/16	1/2"	47910985
			3/4"	47910458
1"	25	1"5/16	1"	47910459
1"1/4	32	1"5/8	1"1/4	47910460
1"1/2	38	1"7/8	1"1/2	47910461

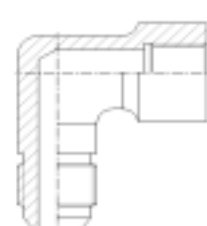

## Té Mâle JIC X Femelle NPTF au centre

Diamètre tube		JIC	NPTF	Référence
mm	inch			
1/4"	6	7/16"	1/8"	47911115
			1/4"	47911117
5/16"	8	1/2"	1/8"	47911118
3/8"	10	9/16"	1/4"	47911119
1/2"	12	3/4"	3/8"	47911120
5/8"	16	7/8"	1/2"	47911121
3/4"	20	1"1/16	3/4"	47911122
1"	25	1"5/16	1"	47911123
1"1/4"	32	1"5/8	1"1/4"	47911224

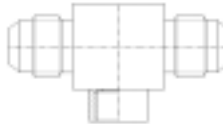

## Té Mâle JIC X Femelle NPTF Renversée

Diamètre tube		JIC	NPTF	Référence
mm	inch			
1/4"	6	7/16"	1/8"	47911141
			1/4"	47911142
5/16"	8	1/2"	1/8"	47911143
3/8"	10	9/16"	1/4"	47911144
1/2"	12	3/4"	3/8"	47911145
			1/2"	47911806
5/8"	16	7/8"	1/2"	47911146
3/4"	20	1"1/16	3/4"	47911147
1"	25	1"5/16	1"	47911148
1"1/4"	32	1"5/8	1"1/4"	47911221

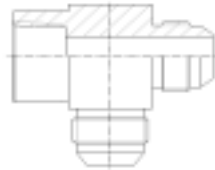

## Femelle JIC Tournant X Mâle NPTF

Diamètre tube		JIC	NPTF	Référence
mm	inch			
1/4"	6	7/16"	1/8"	47911868
			1/4"	47912310
5/16"	8	1/2"	1/4"	47912311
3/8"	10	9/16"	1/4"	47912312
			3/8"	47912313
1/2"	12	3/4"	3/8"	47912314
			1/2"	47911869
5/8"	16	7/8"	3/8"	47912315
			1/2"	47912316
3/4"	20	1"1/16	1/2"	47912317
			3/4"	47912318
1"	25	1"5/16	3/4"	47912319
			1"	47912320
1"1/4"	32	1"5/8	1"1/4"	47912321



## Mâle JIC X Mâle Gaz Conique

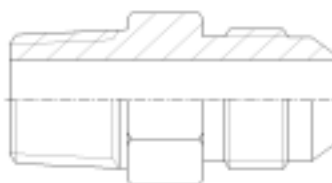

Diamètre tube		JIC	BSPT	Référence
mm	inch			
1/4"	6	7/16"	1/8"	47910141
			1/4"	47910143
			3/8"	47911848
5/16"	8	1/2"	1/8"	47911706
			1/4"	47910144
			3/8"	47911486
			1/2"	47911707
3/8"	10	9/16"	1/4"	47910145
			3/8"	47910147
			1/2"	47911487
1/2"	12	3/4"	1/4"	47910146
			3/8"	47910148
			1/2"	47910150
			3/4"	47911708
5/8"	16	7/8"	3/8"	47910149
			1/2"	47910151
			3/4"	47910152
3/4"	20	1"1/16	1/2"	47910158
			3/4"	47910153
			1"	47911709
1"	25	1"5/16	3/4"	47911710
			1"	47910154
			1"1/4	47911711
1"1/4	32	1"5/8	1"	47911712
			1"1/4	47910155
1"1/2	38	1"7/8	1"1/4	47911849
			1"1/2	47910156
2"	42	2"1/2	2"	47910157
		3"	2"1/2	47911713

Notre site Web :  
[www.geci.fr](http://www.geci.fr)

## Coude Mâle JIC X Mâle Gaz Conique 90°

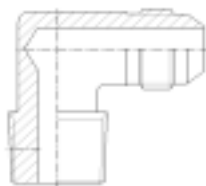

Diamètre tube		JIC	BSPT	Référence
mm	inch			
1/4"	6	7/16"	1/8"	47910361
			1/4"	47910363
5/16"	8	1/2"	1/8"	47910950
			1/4"	47910364
3/8"	10	9/16"	1/8"	47910951
			1/4"	47910365
			3/8"	47910367
			1/2"	47910952
1/2"	12	3/4"	1/4"	47910366
			3/8"	47910368
			1/2"	47910370
			3/4"	47910953
5/8"	16	7/8"	3/8"	47910369
			1/2"	47910371
			3/4"	47910372
3/4"	20	1"1/16	1/2"	47910954
			3/4"	47910373
			1"	47910955
1"	25	1"5/16	3/4"	47910956
			1"	47910374
1"1/4	32	1"5/8	1"	47910957
			1"1/4	47910375
1"1/2	38	1"7/8	1"1/2	47910376

un parc machine important adapté  
à vos demandes

## Coude Mâle JIC X Mâle Gaz Conique 45°

Diamètre tube		JIC	BSPT	Référence
mm	inch			
1/4"	6	7/16"	1/8"	47911032
			1/4"	47911033
5/16"	8	1/2"	1/8"	47911034
			1/4"	47911035
3/8"	10	9/16"	1/4"	47911036
			3/8"	47911037
			1/2"	47911038
1/2"	12	3/4"	1/4"	47911064
			3/8"	47911039
			1/2"	47911040
			3/4"	47911068
5/8"	16	7/8"	3/8"	47911066
			1/2"	47911041
3/4"	20	1"1/16	1/2"	47911067
			3/4"	47911042
1"	25	1"5/16	1"	47911069

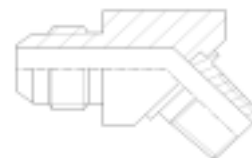

## Mâle JIC X Mâle Gaz Cylindrique (bague+joint)

Diamètre tube		JIC	BSPP	Référence
mm	inch			
1/4"	6	7/16"	1/8"	47911747
			1/4"	47911748
			3/8"	47911749
			1/2"	47911750
5/16"	8	1/2"	1/8"	47911950
			1/4"	47911751
			3/8"	47911752
3/8"	10	9/16"	1/8"	47911696
			1/4"	47911753
			3/8"	47911754
			1/2"	47911755
1/2"	12	3/4"	1/4"	47911756
			3/8"	47911757
			1/2"	47911758
			3/4"	47911759
5/8"	16	7/8"	3/8"	47911760
			1/2"	47911761
			3/4"	47911698
3/4"	20	1"1/16	3/8"	47912236
			1/2"	47911762
			3/4"	47911763
			1"	47911764
1"	25	1"5/16	3/4"	47911765
			1"	47911766
			1"1/4	47911767
1"1/4	32	1"5/8	1"	47911699
			1"1/4	47911768
			1"1/2	47911951
1"1/2	38	1"7/8	1"1/4	47912203
			1"1/2	47911769
2"	50	2"1/2	1"1/2	47912237



## Coude Mâle JIC X Mâle Gaz Cylindrique (bague+joint) 90°

Diamètre tube		JIC	BSPP	Référence
mm	inch			
1/4"	6	7/16"	1/8"	47912444
			1/4"	47910970
			3/8"	47910875
5/16"	8	1/2"	1/8"	47910890
			1/4"	47910971
			3/8"	47910891
3/8"	10	9/16"	1/4"	47910972
			3/8"	47910973
			1/2"	47910896
1/2"	12	3/4"	1/4"	47910974
			3/8"	47910975
			1/2"	47910976
			3/4"	47910897
5/8"	16	7/8"	3/8"	47910892
			1/2"	47910977
			3/4"	47910893
3/4"	20	1"1/16	1/2"	47910978
			3/4"	47910979
			1"	47910894
1"	25	1"5/16	3/4"	47910980
			1"	47910981
1"1/4	32	1"5/8	1"	47910982
			1"1/4	47912445
1"1/2	38	1"7/8	1"1/4	47912454
			1"1/2	47912446

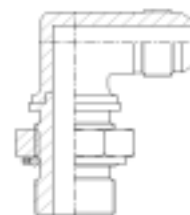

## Coude Mâle JIC X Mâle Gaz Cylindrique (bague+joint) 45°

Diamètre tube		JIC	BSPP	Référence
mm	inch			
1/4"	6	7/16"	1/8"	47919070
5/16"	8	1/2"	1/8"	47919071
3/8"	10	9/16"	1/4"	47901050
1/2"	12	3/4"	3/8"	47911051
5/8"	16	7/8"	1/2"	47919072
3/4"		1"1/16	3/4"	47911052
1"	25	1"5/16	1"	47919073
1"1/4	32	1"5/8	1"1/4	47919074
1"1/2	38	1"7/8	1"1/2	47919075

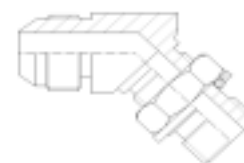

# Plus de 4.500 références

## Té Mâle JIC X Mâle Gaz Cylindrique (bague+joint) au centre

Diamètre tube		JIC	BSPP	Référence
mm	inch			
1/4"	6	7/16"	1/8"	47912167
5/16"	8	1/2"	1/8"	47912168
3/8"	10	9/16"	1/4"	47912160
1/2"	12	3/4"	3/8"	47912161
5/8"	16	7/8"	1/2"	47912162
3/4"	20	1"1/16	3/4"	47912163
1"	25	1"5/16	1"	47912164
1"1/4"	32	1"5/8	1"1/4"	47912165
1"1/2"	38	1"7/8	1"1/2"	47912166

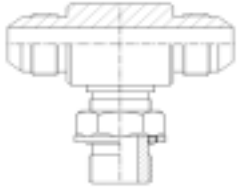

## Té Mâle JIC X Mâle Gaz Cylindrique (bague+joint) Renversé

Diamètre tube		JIC	BSPP	Référence
mm	inch			
1/4"	6	7/16"	1/8"	47912170
5/16"	8	1/2"	1/8"	47912169
3/8"	10	9/16"	1/4"	47912171
1/2"	12	3/4"	3/8"	47912172
5/8"	16	7/8"	1/2"	47912173
3/4"	20	1"1/16	3/4"	47912174
1"	25	1"5/16	1"	47912176
1"1/4"	32	1"5/8	1"1/4"	47912177
1"1/2"	38	1"7/8	1"1/2"	47912178

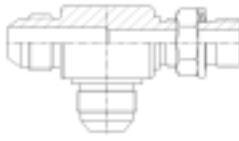

## Mâle JIC X Femelle Gaz Cylindrique

Diamètre tube		JIC	BSPP	Référence
mm	inch			
1/4"	6	7/16"	1/8"	47910511
			1/4"	47910513
5/16"	8	1/2"	1/8"	47910512
			1/4"	47910514
			3/8"	47910517
3/8"	10	9/16"	1/4"	47910515
			3/8"	47910518
1/2"		3/4"	1/4"	47910516
			3/8"	47910519
			1/2"	47910521
5/8"	16	7/8"	1/2"	47910522
			3/4"	47910524
3/4"	20	1"1/16	1/2"	47910523
			3/4"	47910525
1"	25	1"5/16	1"	47910526
1"1/4"	32	1"5/8	1"1/4"	47910527
1"1/2"	38	1"7/8	1"1/2"	47910528
2"	42	2"1/2	2"	47910529



Femelle JIC X Mâle Gaz Conique				
Diamètre tube		JIC	BSPT	Référence
mm	inch			
1/4"	6	7/16"	1/8"	47911887
			1/4"	47912322
5/16"	8	1/2"	1/4"	47912323
3/8"	10	9/16"	1/4"	47912324
			3/8"	47911888
1/2"	12	3/4"	1/4"	47912325
			3/8"	47912326
			1/2"	47911889
5/8"	16	7/8"	1/2"	47912327
3/4"	20	1"1/16	1/2"	47912328
			3/4"	47912329
1"	25	1"5/16	3/4"	47912330
			1"	47912331
1"1/4	32	1"5/8	1"1/4	47912332

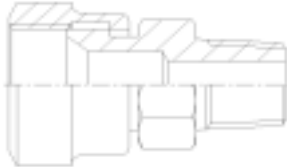

Femelle JIC X Mâle Gaz Cylindrique (bague+joint)				
Diamètre tube		JIC	BSPP	Référence
mm	inch			
1/4"	6	7/16"	1/8"	47911870
			1/4"	47911890
5/16"	8	1/2"	1/8"	47911880
			1/4"	47911871
3/8"	10	9/16"	1/4"	47911872
			3/8"	47911873
			1/2"	47911891
1/2"	12	3/4"	1/4"	47911881
			3/8"	47911874
			1/2"	47911892
5/8"	16	7/8"	3/8"	47911882
			1/2"	47911875
3/4"	20	1"1/16	1/2"	47911883
			3/4"	47911876
1"	25	1"5/16	3/4"	47911884
			1"	47911877
			1"1/4	47911893
1"1/4	32	1"5/8	1"	47911885
			1"1/4	47911878
1"1/2	38	1"7/8	1"1/4	47911886
			1"1/2	47911879



**Livraison sous 24 heures**

Mâle JIC X Mâle Métrique Cylindrique (bague+joint)				
Diamètre tube		JIC	Métrique	Référence
mm	inch			
1/4"	6	7/16"	M 10 X 100	47912281
			M 12 X 150	47912293
			M 14 X 150	47912294
5/16"	8	1/2"	M 12 X 150	47912282
3/8"	10	9/16"	M 14 X 150	47912283
			M 16 X 150	47912284
			M 18 X 150	47912295
1/2"	12	3/4"	M 16 X 150	47912285
			M 18 X 150	47912296
5/8"	16	7/8"	M 18 X 150	47912286
			M 22 X 150	47912287
3/4"	20	1"1/16	M 22 X 150	47912288
			M 26 X 150	47912299
			M 27 X 200	47912289
1"	25	1"1/16	M 33 X 200	47912290
1"1/4	32	1"5/8	M 42 X 200	47912291
1"1/2	38	1"7/8	M 52 X 200	47912292

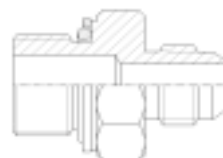

Coude Mâle JIC X Mâle Métrique Cylindrique (bague+joint) 90°				
Diamètre tube		JIC	Métrique	Référence
mm	inch			
1/4"	6	7/16"	M 10 X 100	47912270
			M 12 X 150	47912258
5/16"	8	1/2"	M 12 X 150	47912271
3/8"	10	9/16"	M 14 X 150	47912272
			M 16 X 150	47912259
1/2"	12	3/4"	M 16 X 150	47912273
			M 18 X 150	47912268
5/8"	16	7/8"	M 18 X 150	47912274
			M 22 X 150	47912275
3/4"	20	1"1/16	M 22 X 150	47912276
			M 27 X 200	47912277
1"	25	1"1/16	M 30 X 200	47912278
			M 33 X 200	47912279
1"1/4		1"5/8	M 42 X 200	47912280

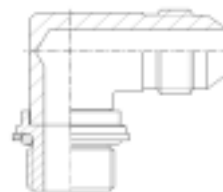

Réalisation de pièces spéciales  
sur demande

## Femelle JIC X Mâle Métrique Cylindrique (bague+joint)

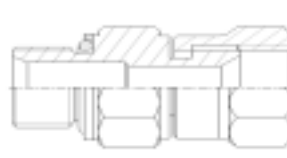
Diamètre tube		JIC	Métrique	Référence	
mm	inch				
1/4"	6	7/16"	M 10 x 100	47912220	
5/16"	8	1/2"	M 12 X 150	47912221	
3/8"	10	9/16"	M 14 X 150	47912222	
1/2"	12	3/4"	M 16 X 150	47912223	
5/8"	16	7/8"	M 22 X 150	47912224	
3/4"	20	1"1/16	M 27 X 200	47912225	
1"	25	1"5/16	M 33 X 200	47912226	
1"1/4	32	1"5/8	M 42 X 200	47912227	
1"1/2	38	1"7/8	M 50 X 200	47912228	

## Union Inégale Mâle JIC X Mâle JIC



Diamètre tube		JIC	Diamètre tube		JIC	Référence
mm	inch		mm	inch		
5/16"	8	1/2"	1/4"	6	7/16"	47911906
3/8"	10	9/16"	1/4"	6	7/16"	47910239
1/2"	12	3/4"	3/8"	10	9/16"	47911701
5/8"	16	7/8"	1/2"	12	3/4"	47911702
3/4"	20	1"1/16	5/8"	16	7/8"	47911909
1"	25	1"5/16	3/4"	20	1"1/16	47910078

## Coude Inégal Mâle JIC X Mâle JIC 90°

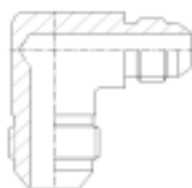

Diamètre tube		JIC	Diamètre tube		JIC	Référence
mm	inch		mm	inch		
1/2"	12	3/4"	3/8"	10	9/16"	47910945
1"	25	1"5/16	3/4"	20	1"1/16	47910946

un parc machine important adapté  
à vos demandes

## Réduction Femelle JIC X Mâle JIC



Diamètre tube A		Diamètre tube B		JIC	JIC	Référence
mm	inch	mm	inch			
5/16"	8	1/4"	6	1/2"	7/16"	47912187
3/8"	10	1/4"	6	9/16"	7/16"	47911773
		5/16"	8		1/2"	47911775
1/2"	12	1/4"	6	3/4"	7/16"	47911774
		5/16"	8		1/2"	47911776
		3/8"	10		9/16"	47911777
5/8"	16	1/4"	6	7/8"	7/16"	47912191
		5/16"	8		1/2"	47911952
		3/8"	10		9/16"	47911778
		1/2"	12		3/4"	47911780
3/4"	20	1/4"	6	1"1/16	7/16"	47912192
		5/16"	8		1/2"	47911953
		3/8"	10		9/16"	47911779
		1/2"	12		3/4"	47911781
		5/8"	16		7/8"	47911782
1"	25	5/16"	8	1"5/16	1/2"	47911954
		1/2"	12		3/4"	47911955
		5/8"	16		7/8"	47911956
		3/4"	20		1"1/16	47911783
1"1/4	32	5/16"	8	1"5/8	1/2"	47911957
		1/2"	12		3/4"	47911958
		5/8"	16		7/8"	47911959
		3/4"	20		1"1/16	47911784
		1"	25		1"1/16	47911785
1"1/2	38	5/8"	16	1"7/8	1/2"	47911960
		3/4"	20		3/4"	47911961
		5/8"	16		7/8"	47911962
		3/4"	20		1"1/16	47911963
		1"	25		1"5/16	47911964
		1"1/4	32		1"5/8	47911786

## Ecrou Hexagonal Tube Métrique

Diamètre tube		JIC	Référence
mm			
1/4"	6	7/16"	47910230
5/16"	8	1/2"	47910231
3/8"	10	9/16"	47910232
1/2"	12	3/4"	47910233
5/8"	16	7/8"	47910234
3/4"	20	1"1/16	47910235
1"	25	1"5/16	47910237
1"1/4	32	1"5/8	47910238
1"1/2	38	1"7/8	47910239

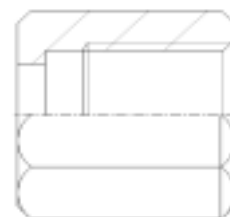

Bouchon Femelle JIC			
Diamètre tube		JIC	Référence
mm	inch		
1/4"	6	7/16"	47910623
5/16"	8	1/2"	47910624
3/8"	10	9/16"	47910625
1/2"	12	3/4"	47910626
5/8"	16	7/8"	47910627
3/4"	20	1"1/16	47910628
1"	25	1"5/16	47910629
1"1/4	32	1"5/8	47910630
1"1/2	38	1"7/8	47910631
2"	42	2"1/2	47910632

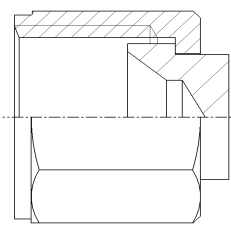

Bouchon Mâle JIC			
Diamètre tube		JIC	Référence
mm	inch		
1/4"	6	7/16"	47910606
5/16"	8	1/2"	47910607
3/8"	10	9/16"	47910608
1/2"	12	3/4"	47910609
5/8"	16	7/8"	47910610
3/4"	20	1"1/16	47910611
1"	25	1"5/16	47910612
1"1/4	32	1"5/8	47910613
1"1/2	38	1"7/8	47910614
2"	42	2"1/2	47910681

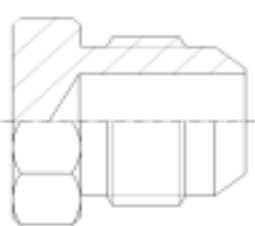

Manchette Tube Métrique		
Diamètre tube	Référence	
6	47102801	
8	47102802	
10	47102803	
12	47102804	
14	47102805	
15	47102815	
16	47102806	
18	47102807	
20	47102808	
25	47102810	
30	47102811	
32	47102812	
38	47102813	
42	47102816	

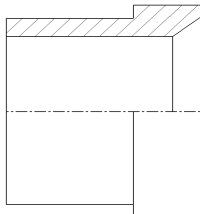

**GECI**  
Fabricant français

# BSP / BSPT



[Sommaire](#)

Mâle BSP (cône 60°) X Mâle BSP (cône 60°)		
FILETAGE BSPP	FILETAGE BSPP	Référence
1/8"	1/8"	47910210
	1/4"	47912333
1/4"	1/4"	47910211
	3/8"	47911505
	1/2"	47911405
3/8"	3/8"	47910212
	1/2"	47911406
	3/4"	47912334
1/2"	1/2"	47911407
	3/4"	47910217
5/8"	5/8"	47910216
	3/4"	47912337
	1"	47912338
3/4"	3/4"	47910218
	1"	47910219
1"	1"	47910220
	1"1/4	47912339
1"1/4	1"1/4	47910221
	1"1/2	47912340
1"1/2	1"1/2	47910222
2"	2"	47910223

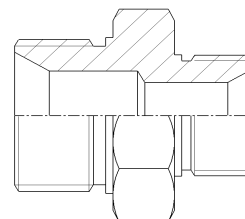

Mâle BSP (cône 60°) X Mâle Gaz Conique		
FILETAGE BSPP	FILETAGE BSPT	Référence
1/8"	1/8"	47912341
	1/4"	47912342
1/4"	1/8"	47912343
	1/4"	47910792
	3/8"	47912344
	1/2"	47912345
3/8"	1/4"	47912346
	3/8"	47912347
	1/2"	47912348
1/2"	3/8"	47912349
	1/2"	47912350
		47912352
5/8"	1/2"	47912353
	5/8"	47912354
	3/4"	47912355
3/4"	1/2"	47912356
	3/4"	47912358
	1"	47912359
1"	3/4"	47912360
	1"	47912361
	1"1/4	47912362
1"1/4	1"	47912363
	1"1/4	47912364
1"1/2	1"1/2	47912365
2"	2"	47912366

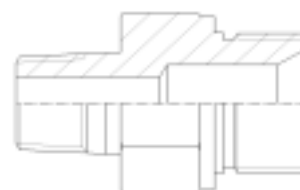

# BSP / BSPT



[Sommaire](#)

## Femelle BSP (cône 60°) X Mâle Gaz Conique

FILETAGE BSPP	FILETAGE BSPT	Référence
1/8"	1/8"	47912531
1/4"	1/4"	47912532
3/8"	3/8"	47912533
	1/2"	47912534
1/2"	3/8"	47912535
	1/2"	47912536
3/4"	3/4"	47912538
1"	1"	47912539

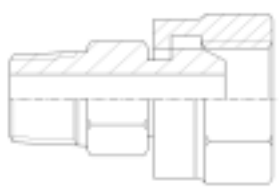

## Mâle BSP (cône 60°) X Femelle BSP (cône 60°)

FILETAGE BSPP	FILETAGE BSPP	Référence
1/4"	1/4"	47912580
3/8"	3/8"	47912583
1/2"	1/2"	47912586
3/4"	3/4"	47912589



## Mâle Gaz Conique X Mâle Gaz Conique

FILETAGE BSPT	FILETAGE BSPT	Référence
1/8"	1/8"	47912516
	1/4"	47912517
1/4"	1/4"	47912518
	3/8"	47912519
	1/2"	47912520
3/8"	3/8"	47912521
	1/2"	47912522
1/2"	1/2"	47912523
	3/4"	47912524
3/4"	3/4"	47912525
	1"	47912526
1"	1"	47912527
1"1/4	1"1/4	47912528
1"1/2	1"1/2	47912529
2"	2"	47912530

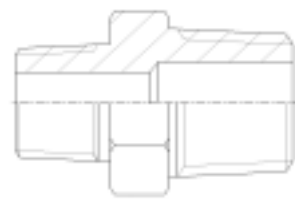

# Inox 316 L

# BSP / BSPT



[Sommaire](#)

## Mâle Gaz Conique X Mâle NPT

Filetage BSPT	FILETAGE NPTF	Référence
1/8"	1/8"	47910530
	1/4"	47910546
1/4"	1/8"	47910531
	1/4"	47910532
3/8"	1/4"	47910533
	3/8"	47910534
1/2"	3/8"	47910535
	1/2"	47910536
3/4"	1/2"	47910537
	3/4"	47910538
	1"	47910547
1"	3/4"	47910539
	1"	47910540
1"1/4	1"	47910541
	1"1/4	47910542
1"1/2	1"1/2	47910543
2"	2"	47910544

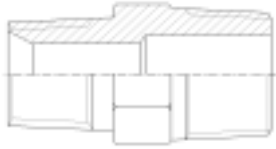

## Mâle Gaz Conique X Femelle Gaz Cylindrique

Filetage BSPT	Filetage BSPP	Référence
1/4"	1/8"	47911792
	1/4"	47912508
3/8"	1/8"	47911793
	1/4"	47911794
1/2"	1/8"	47911795
	1/4"	47911796
	3/8"	47911797
3/4"	1/4"	47911798
	3/8"	47911799
	1/2"	47912300
1"	1/2"	47912301
	3/4"	47912302
1"1/4	1"	47912303
1/4"	1/4"	47912508
	3/8"	47912509
	1/2"	47912510
3/8"	3/8"	47912511
		47912512
1/2"	1/2"	47912513
	3/4"	47912514
3/4"	1"	47912515

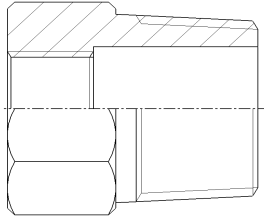

## Coude Mâle Gaz Conique X Femelle Gaz Cylindrique 90°

Filetage BSPT	Filetage BSPP	Référence
1/4"	1/4"	47910996
3/8"	3/8"	47910997
1/2"	1/2"	47910998
3/4"	3/4"	47910999
1"	1"	47912403
1"1/4	1"1/4	47912404
1"1/2	1"1/2	47912405
2"	2"	47912406

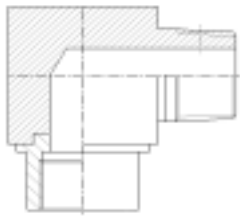

## Femelle Gaz Cylindrique X Femelle Gaz Cylindrique

FILETAGE BSPP	FILETAGE BSPP	Référence
1/8"	1/8"	47912382
	1/4"	47912383
1/4"	1/4"	47912384
	3/8"	47912385
3/8"	3/8"	47912386
	1/2"	47912387
1/2"	1/2"	47912388
3/4"	1/2"	47912389
	3/4"	47912390
1"	3/4"	47912391
	1"	47912392
1"1/4	1"1/4	47912393
1"1/2	1"1/2	47912394
2"	2"	47912395

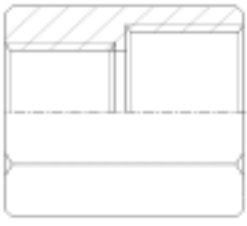

## Coude Femelle Gaz Cylindrique X Femelle Gaz Cylindrique 90°

FILETAGE BSPP	FILETAGE BSPP	Référence
1/8"	1/8"	47912414
1/4"	1/4"	47912415
3/8"	3/8"	47912416
1/2"	1/2"	47912417
3/4"	3/4"	47912418
1"	1"	47912419
1"1/4	1"1/4	47912420

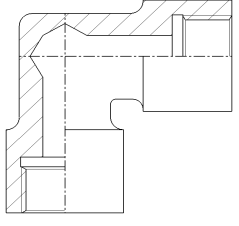

## Té Egal Femelle Gaz Cylindrique

BSPP	Référence
1/4"	47911825
3/8"	47911826
1/2"	47911827
3/4"	47911828
1"	47911829
1"1/4	47911830

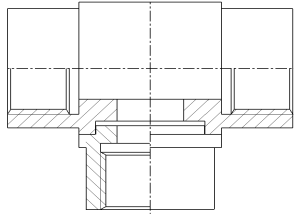

**70.000 raccords hydrauliques en stock**

# NPT



[Sommaire](#)

## Mâle NPT X Mâle NPT

FILETAGE NPTF	FILETAGE NPTF	Référence
1/8"	1/8"	47910550
1/4"	1/8"	47910551
1/4"	1/4"	47910552
3/8"	1/8"	47911788
3/8"	1/4"	47910553
3/8"	3/8"	47910554
1/2"	1/4"	47910555
1/2"	3/8"	47910556
1/2"	1/2"	47910557
3/4"	3/8"	47910633
3/4"	1/2"	47910558
3/4"	3/4"	47910559
1/2"	1"	47911789
1"	3/4"	47911790
1"	1"	47910561
1"	1"1/4"	47910562
1"1/4"	1"1/4"	47910563
1"1/2"	1"1/2"	47910564
2"	2"	47910565
2"1/2"	2"1/2"	47910751

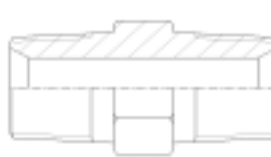

## Réduction Femelle NPT X Mâle NPT

FILETAGE NPTF	FILETAGE NPTF	Référence
1/8"	1/4"	47910570
	3/8"	47910571
	1/2"	47910573
1/4"	1/8"	47912500
	3/8"	47912501
	1/2"	47910574
	3/4"	47910576
3/8"	1/2"	47910575
	3/4"	47910566
	1"	47910567
1/2"	3/8"	47912502
	3/4"	47910568
		47910569
3/4"	1/2"	47912503
	1"	47910577
	1"1/4"	47910578
	1"1/2"	47910579
1"	1"1/4"	47910580
	1"1/2"	47910581
	2"	47910582
1"1/4"	1"1/2"	47910583
	2"	47910584
1"1/2"	2"	47910585

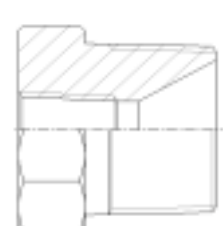

# NPT



[Sommaire](#)

## Coude Mâle NPT X Mâle NPT à 90°

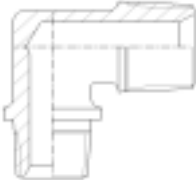
FILETAGE NPTF	FILETAGE NPTF	Référence	
1/8"	1/8"	47910380	
1/4"	1/4"	47910381	
1/4"	3/8"	47910382	
3/8"	3/8"	47910383	
3/8"	1/2"	47910384	
1/2"	1/2"	47910385	
1/2"	3/4"	47910386	
3/4"	3/4"	47910387	
3/4"	1"	47910388	
1"	1"	47910389	

## Coude Mâle NPT X Femelle NPT à 90°

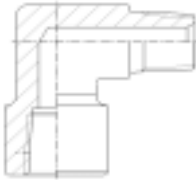
FILETAGE Femelle NPTF	FILETAGE Mâle NPTF	Référence	
1/8"	1/8"	47910498	
	1/4"	47910994	
1/4"	1/8"	47910499	
	1/4"	47910900	
	3/8"	47910901	
3/8"	1/4"	47910902	
	3/8"	47910903	
	1/2"	47910904	
1/2"	3/8"	47910905	
	1/2"	47910906	
	3/4"	47910907	
3/4"	1/2"	47910908	
	3/4"	47910909	
1"	1"	47910910	
1"1/4	1"1/4	47910995	

Marquage unitaire des pièces :  
traçabilité totale

## Mâle NPT X Mâle BSP (Cône 60°)

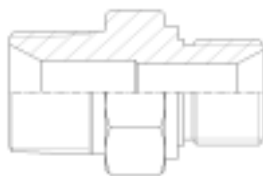

FILETAGE NPTF	FILETAGE BSPF	Référence
1/8"	1/8"	47910588
1/4"	1/4"	47910589
	3/8"	47912369
	1/2"	47912368
3/8"	1/4"	47912367
	3/8"	47910590
	1/2"	47912370
1/2"	1/4"	47912371
	3/8"	47912372
	1/2"	47910591
	3/4"	47912373
5/8"	1/2"	47910592
	3/4"	47912374
3/4"	1/2"	47910593
	3/4"	47910594
	1"	47912375
1"	3/4"	47912376
	1"	47910595
	1"1/4	47912377
1"1/4"	1"	47910596
	1"1/4	47912378
	1"1/2	47912379
1"1/2	1"1/2	47912380
2"	2"	47912381

Notre site Web :  
[www.geci.fr](http://www.geci.fr)

# Bouchon



[Sommaire](#)

## Bouchon Mâle NPT

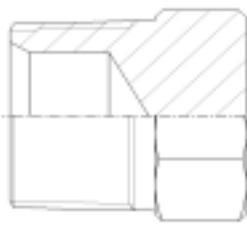
FILETAGE NPTF	Référence	
1/8"	47910600	
1/4"	47910601	
3/8"	47910602	
1/2"	47910603	
3/4"	47910604	
1"	47910605	
1"1/4	47910640	
1"1/2	47910682	
2"	47910683	

## Bouchon Mâle BSP (cône 60°)

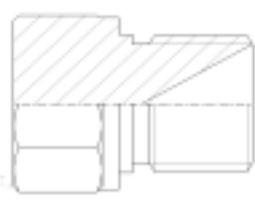
FILETAGE BSPP	Référence	
1/8"	47912900	
1/4"	47912901	
3/8"	47912902	
1/2"	47912903	
3/4"	47912905	
1"	47912906	
1"1/4	47912907	
1"1/2	47912908	
2"	47912909	

## Bouchon Mâle Gaz Conique

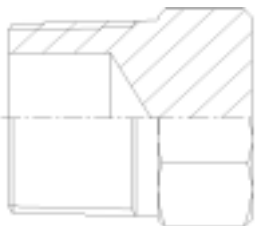
FILETAGE BSPT	Référence	
1/8"	47910684	
1/4"	47910685	
3/8"	47910686	
1/2"	47910687	
3/4"	47910688	
1"	47910689	
1"1/4	47910690	
1"1/2	47910691	

**Plus de 4.500 références**